

PK55XX/RFK55XX-433

Installation Instructions, Instructions d'Installation, Instrucciones de instalación, Instruções de instalação

English, Français, Español, Português



PK5500
RFK5500



PK5501
RFK5501



PK5508
RFK5508



PK5516
RFK5516

WARNING: Please refer to the System Installation Manual for information on limitations regarding product use and function and information on the limitations as to liability of the manufacturer.

NOTE: These instructions shall be used in conjunction with the system Installation Manual of the Control Panel with which this equipment is intended to be used.

ATTENTION: Ce manuel contient des informations sur les restrictions concernant le fonctionnement et l'utilisation du produit et des informations sur les restrictions en ce qui concerne la responsabilité du fabricant. La totalité du manuel doit être lu attentivement.

NOTE: Ce manuel doit être utilisé en conjonction avec le Manuel d'installation du Panneau de contrôle.

ATENCIÓN: Consulte el Manual de instalación del sistema para obtener información sobre las limitaciones del uso y funciones del producto, así como las limitaciones de la responsabilidad del fabricante.

NOTA: Estas instrucciones deberán utilizarse conjuntamente con el Manual de instalación del sistema del Panel de control con el que se vaya a utilizar este equipo.

AVISO: Consulte o Manual de instalação do sistema para obter informações acerca das limitações relativas à utilização do produto e funções e informações acerca das limitações relativas à imputação de responsabilidades ao fabricante.

NOTA: Estas instruções devem ser utilizadas em conjunto com o Manual de instalação do sistema do painel de controlo com o qual este equipamento se destina a ser utilizado.

DSC®



PowerSeries™

SECURITY SYSTEM



29007203R002

English Installation Instructions

The PK55XX/RFK55XX keypads can be used on security systems with up to 64 zones. These keypads are compatible with the following DSC security systems:

- PC580
- PC1616
- PC5008
- PC5020
- PC585
- PC1832
- PC5010
- PC1555MX
- PC1864
- PC5015
- PC1565
- PC5005
- PC5016

The RFK55XX keypads combine a wireless receiver with the respective PK55XX keypad.

Specifications

- Temperature range: -10°C to +55°C (14°F to 131°F), Temperature range for UL/ULC: 0°C to +49°C (32°F to 120°F)
- Humidity (MAX): 93%RH.
- Plastic enclosure protection degree: IP30, IK04
- Voltage rating: 12Vdc nominal
- Connects to control panel via 4-wire Keybus
- 1 keypad zone input/PGM output*
- PK55XX Current draw: 50mA (standby)/125mA (maximum)
- RFK55XX Current draw: 75mA (standby)/135mA (maximum)
- Wall mount tamper
- 5 programmable function keys
- Ready (Green LED), Armed (Red LED), Trouble (Yellow LED), AC (Green LED)
- Low temperature sensor
- Frequency: 433.92MHz (RFK55XX-433 Only)
- Up to 32 wireless zones (RFK55XX Only)

NOTE: * Zone not to be programmed as Fire type or 24h type.

Unpacking

The Power keypad package includes the following parts:

- One Power keypad
- Four mounting screws
- 2 end-of-line resistors
- Keypad inner door labels
- 1 tamper switch
- Installation Instructions

Mounting

You should mount the keypad where it is accessible to designated points of entry and exit. Once you have selected a dry and secure location, perform the following steps to mount the keypad.

Disassemble Keypad

1. Removing the keypad from the backplate for the first time.
 - (a) Position the keypad as indicated, insert screwdriver and rotate.

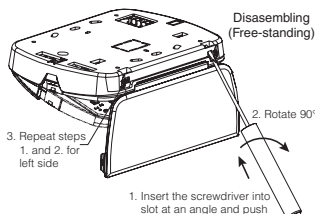

2. Removing the keypad from backplate once mounted.
 - (a) Open door, holding it 90° to the keypad, as shown below.
 - (b) Insert screwdriver into slot located under the door hinge and rotate the screwdriver.

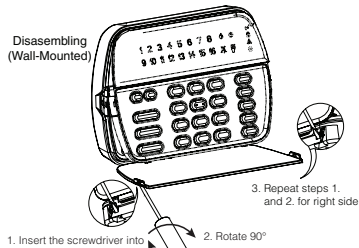

Mount and Wire Keypad

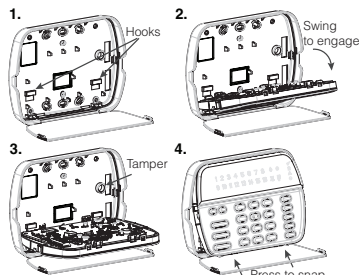
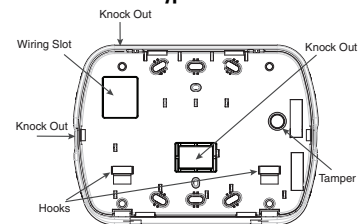

1. Secure Keypad to wall using mounting holes. Use all 4 screws provided unless mounting on a single gang box.
2. Place keypad into hooks on the backplate and swing down to engage.
3. Run wire through wiring slot or knockouts. Connect Keybus and PGM/Zone wiring to keypad. Place tamper switch into tamper hole on backplate.
4. Remove keypad from hooks. Place keypad into backplate, ensure the wire is pushed back into the wall as much as possible. Route the wire inside the keypad ensuring high components are avoided. Snap the front assembly closed, ensuring that there is no pressure to the keypad from the wire below.

NOTE: If any tension found between the front keypad assembly and wiring, please open the keypad reroute the wire and close again. Repeat these steps until the keypad is closed properly.

Wiring

1. Before wiring the unit, ensure that all power (AC transformer and battery) is disconnected from the control panel.
 2. Connect the four Keybus wires from the control panel (red, black, yellow and green) to the keypad terminals. Refer to diagram:
- | | |
|---------|-----------------------|
| | PK55XX/RFK55XX |
| RED — R | ⊕ |
| BLK — B | ⊖ |
| YEL — Y | P |
| GRN — G | Z |
| | To zone or PGM output |
3. If programmed as an input, you can connect a device - such as a door contact - to the 'P/Z' terminal of the keypad. This eliminates the need to run wires back to the control panel for the device. To connect the zone, run one wire from the device to the 'P/Z' terminal and the other wire from the device to the B (black) terminal. For powered devices, run the red wire to the R (positive) terminal and the black wire to the B (negative) terminal. When using end of line supervision, connect the zone according to one of the configurations outlined in your system's Installation Manual.
 4. If the 'P/Z' terminal is programmed as an output, the output follows the PGM programmed in Section [080]. A small relay, buzzer or other DC

operated device may be connected between the positive supply voltage and the 'P/Z' terminal (maximum load is 50mA).

NOTE: For UL Residential Fire Installations use at least one additional DSC compatible keypad in conjunction with an RFK55XX-433 keypad or install the RFK55XX-433 keypads within 3 feet from the control unit and mechanically protect the keybus wires

Applying Power

Once all wiring is complete, and the equipment is secured to the building structure with at least two screws apply power to the control panel:

1. Connect the battery leads to the battery.

2. Connect the AC transformer.

For more information on control panel power specifications, see the control panel Installation Manual.

Programming the Keypad

There are several programming options available for the keypad. These are described below. Programming the keypad is similar to programming the rest of the system. When you are in the keypad programming sections, the keypad will display which options are turned on along the top of the display. To turn an option

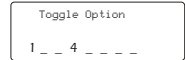
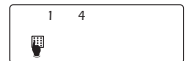

on or off, press the number corresponding to the option on the number pad. The numbers of the options that are currently turned ON will be displayed. For example, if options 1 and 4 are on, the display will look like this on the different keypad displays:

For information on programming the rest of your security system, please refer to your system's Installation Manual.

Broadcasting LCD Labels

All LCD programming is done per keypad. If more than one LCD keypad is present on the system, labels programmed at one keypad can be broadcast to all other LCD keypads. Perform the following procedure in order to broadcast labels:

Step 1 - Program one LCD keypad completely.

Step 2 - Make sure all LCD keypads are connected to the Keybus.

Step 3 - Enter keypad programming by pressing **[*][8][Installer Code][*]**, then enter section [998] at the keypad that was programmed. The keypad will now broadcast all the information programmed to all the other LCD keypads on the system.

Step 4 - When the keypad is finished press the **[#]** key to exit.

NOTE: Label broadcast from this keypad is only compatible with other PK5500 and RFK5500 Keypads.

Language Programming (PK5500/RFK5500 Only)

Hold (<>) keys for 2 seconds to enter language programming, scroll to the desired language and Press **[*]** to select.

NOTE: If section [077] option 4 is OFF, language programming can only be performed while in installers programming.

Enrolling the Keypad

The keypad will need to be assigned to a partition and slot if supervision or keypad zones are being used. Keypad assignments and keypad option programming must be done at each keypad individually.

The 1st digit of keypad assignment is used to determine partition assignment (1 to 8). If partitioning is not used, enter [1]. For Global Keypads, enter [0].

NOTE: LED and ICON keypads cannot be programmed as Global Keypads

The 2nd digit of keypad assignment is used to determine slot assignment for keypad supervision. Each keypad will be assigned a different slot number from 1 to 8. PK5500 and RFK5500 LCD keypads come defaulted in slot 8. If LCD keypads are used one LCD keypad must remain in slot 8.

NOTE: The RFK55XX enrolls as two modules:

Light 1 = keypad section of the RFK55XX

Light 17 = receiver section of the RFK55XX

NOTE: Deleting all wireless devices from the RFK55XX or defaulting the RFK55XX will cause a supervisory fault.

Enter the following at each keypad installed on the system:

1. Enter Installer Programming by pressing **[*][8][Installer's Code]**

2. Press [000] for Keypad Programming

3. Press [0] for Partition and Slot Assignment

4. Enter the 1st digit (0 to 8 for partition assignment)

5. Enter the 2nd digit (1 to 8 for slot assignment supervision)

6. Press the **[#]** key twice to exit programming.

7. After assigning all keypads, perform a supervisory reset by entering **[*][8][Installer's Code][902]** and wait for 60 seconds.

8. Press the **[#]** key to exit programming after 60 seconds.

Programming Labels (PK5500/RFK5500 Only)

1. Enter keypad programming by pressing **[*][8][Installer Code][*]**. Enter the 3-digit section number for the label to be programmed.

2. Use the arrow keys (<>) to move the underline bar underneath the letter to be changed.

3. Press the number keys [1] to [9] corresponding to the letter you require. The first time you press the number the first letter will appear. Pressing the number key again will display the next letter.

[1] - A, B, C, 1 [4] - J, K, L, 4 [7] - S, T, U, 7 [0] - Space

[2] - D, E, F, 2 [5] - M, N, O, 5 [8] - V, W, X, 8

[3] - G, H, I, 3 [6] - P, Q, R, 6 [9] - Y, Z, 9, 0

4. When the required letter or number is displayed use the arrow keys (<>) to scroll to the next letter.

5. When you are finished programming the Zone Label, press the **[*]** key, scroll to "Save," then press **[*]**.

6. Continue from Step 2 until all Labels are programmed.

NOTE: Label Programming can also be accessed from the **[*][6] User Functions Menu**

ASCII Characters

000	##	001	>	002	<	003	?	004	005	006	007	008	009	010	011	012	013	014	015	016	017	018	019	020	021	022	023	024	025	026	027	028	029	030	031	032	033	034	035	036	037	038	039	040	041	042	043	044	045	046	047	048	049	050	051	052	053	054	055	056	057	058	059	060	061	062	063	064	065	066	067	068	069	070	071	072	073	074	075	076	077	078	079	080	081	082	083	084	085	086	087	088	089	090	091	092	093	094	095	096	097	098	099
-----	----	-----	---	-----	---	-----	---	-----	-----	-----	-----	-----	-----	-----	-----	-----	-----	-----	-----	-----	-----	-----	-----	-----	-----	-----	-----	-----	-----	-----	-----	-----	-----	-----	-----	-----	-----	-----	-----	-----	-----	-----	-----	-----	-----	-----	-----	-----	-----	-----	-----	-----	-----	-----	-----	-----	-----	-----	-----	-----	-----	-----	-----	-----	-----	-----	-----	-----	-----	-----	-----	-----	-----	-----	-----	-----	-----	-----	-----	-----	-----	-----	-----	-----	-----	-----	-----	-----	-----	-----	-----	-----	-----	-----	-----	-----	-----	-----	-----	-----	-----	-----	-----

Changing Brightness/Contrast

LCD Keypads

1. Press **[*][6][Master Code]**.

2. Use the [**<**]**[>**] keys to scroll to either Brightness Control or Contrast Control.

3. Press **[*]** to select the setting you want to adjust.

4. a) 'Brightness Control': There are multiple backlighting levels. Use the [**<**]**[>**] keys to scroll to the desired level.

b) 'Contrast Control': There are 10 different display contrast levels. Use the [**<**]**[>**] keys to scroll to the desired contrast level.

6. To exit, press **[#]**.

LED/ICON Keypads

1. Press **[*][6][Master Code]**.

2. Use the [**>**] key to move through the 4 different backlighting levels.

3. The level is automatically saved when you press **[#]** to exit.

Changing the Buzzer Level

LCD Keypads

1. Press **[*][6][Master Code]**.

2. Use the [**<**]**[>**] keys to scroll to Buzzer Control.

3. There are 21 different levels, use the [**<**]**[>**] keys to scroll to the desired level.

4. To exit, press **[#]**.

LED/ICON Keypads

1. Press **[*][6][Master Code]**.

2. Use the [**<**] key to move through the 21 different buzzer levels.

3. The level is automatically saved when you press **[#]** to exit.

Limited Warranty

Digital Security Controls warrants that for a period of 12 months from the date of purchase, the product shall be free of defects in materials and workmanship under normal use and that in fulfillment of any breach of such warranty, Digital Security Controls shall, at its option, repair or replace the defective equipment upon return of the equipment to its repair depot. This warranty applies only to defects in parts and workmanship and not to damage incurred in shipping or handling, or damage due to causes beyond the control of Digital Security Controls such as lightning, excessive voltage, mechanical shock, water damage, or damage arising out of abuse, alteration or improper application of the equipment.

The foregoing warranty shall apply only to the original buyer, and is and shall be in lieu of any and all other warranties, whether expressed or implied and of all other obligations or liabilities on the part of Digital Security Controls. Digital Security Controls neither assumes responsibility for, nor authorizes any other person purporting to act on its behalf to modify or to change this warranty, nor to assume for it any other warranty or liability concerning this product.

In no event shall Digital Security Controls be liable for any direct, indirect or consequential damages, loss of anticipated profits, loss of time or any other losses incurred by the buyer in connection with the purchase, installation or operation or failure of this product.

Warning: Digital Security Controls recommends that the entire system be completely tested on a regular basis. However, despite frequent testing, and due to, but not limited to, criminal tampering or electrical disruption, it is possible for this product to fail to perform as expected.

Important Information: Changes or modifications not expressly approved by Digital Security Controls could void the user's authority to operate this equipment.

FCC Compliance Statement

Caution: Changes or modifications not expressly approved by Digital Security Controls could void your authority to use this equipment.

This equipment generates and uses radio frequency energy and if not installed and used properly, in strict accordance with the manufacturer's instructions, may cause interference to radio and television reception. It has been type tested and found to comply with the limits for Class B device in accordance with the specifications in Subpart "B" of Part 15 of FCC Rules, which are designed to provide reasonable protection against such interference in any residential installation. However, there is no guarantee that interference will not occur in a particular installation. If this equipment does cause interference to television or radio reception, which can be determined by turning the equipment off and on, the user is encouraged to try to correct the interference by one or more of the following measures:

- Re-orient the receiving antenna
- Relocate the alarm control with respect to the receiver
- Move the alarm control away from the receiver
- Connect the alarm control into a different outlet so that alarm control and receiver are on different circuits.

If necessary, the user should consult the dealer or an experienced radio/television technician for additional suggestions. The user may find the following booklet prepared by the FCC helpful: "How to Identify and Resolve Radio/Television Interference Problems". This booklet is available from the U.S. Government Printing Office, Washington, D.C. 20402, Stock # 004-000-00345-4.

This Class B digital apparatus complies with Canadian ICES-003.

Cet appareil numérique de la classe B est conforme à la norme NMB-003 du Canada.
IC:160A-RFK55XX4

The term IC before the radio certification number signifies that the Industry Canada technical specifications were met.

EN5131-1 Grade2/Class II

Operating Instructions shall be made available to the user.

DSC erklærer herved at denne komponenten overholder alle vigtige krav samt andre bestemmelser gitt i direktiv 1999/5/EC.

Por este meio, a DSC, declara que este equipamento está em conformidade com os requisitos essenciais e outras determinações relevantes da Directiva 1999/5/EC.

"DSC bekræfter herved at denna apparat uppfyller de väsentliga kraven och andra relevanta bestämmelser i Direktivet 1999/5/EC".

Con la presente la Digital Security Controls dichiara che questo prodotto è conforme ai requisiti essenziali ed altre disposizioni rilevanti relative alla Direttiva 1999/05/CE.

Por la presente, DSC declara que este equipo está en conformidad con los requisitos esenciales y otros requisitos relevantes de la Directiva 1999/5/EC.

Hierdurch erklärt DSC, daß dieses Gerät den erforderlichen Bedingungen und Voraussetzungen der Richtlinie 1999/5/EC entspricht.

Όλα τα προϊόντα της DSC, έφλησαν ότι αυτή η συσκευή είναι σύμφωνη με τις ουσιαστικές απαιτήσεις και με άλλες τις άλλες σχετικές διατάξεις της Οδηγίας 1999/5/EC.

Hierbij verklaart DSC dat dit toestel in overeenstemming is met de eisen en bepalingen van richtlijn 1999/5/EC.

Par la présente, DSC déclare que cet article est conforme aux exigences essentielles et autres relevantes stipulations de la directive 1999/5/EC.

DSC vakuuttaa laitteen täyttävän direktiivin 1999/5/EC olennaiset vaatimukset.

Hereby, DSC, declares that this device is in compliance with the essential requirements and other relevant provisions of Directive 1999/5/EC.

The complete R & TTE Declaration of Conformity can be found at www.dsc.com/intl/rttedirect.htm.

DSC®

©2006 Digital Security Controls, Toronto, Canada • www.dsc.com
Tech. Support, Centre d'aide: 1-800-387-3630 (Canada, US), 905-760-3036





Keypad Enrollment

Enter keypad programming by pressing [*][8][Installer's Code][000].

[0] Partition / Slot Assignment

Digit	Option	Valid Range	Default	
1st	Partition Assignment (0=Global Keypad)	0 to 8	1	<input type="text"/>
2nd	Slot Assignment	1 to 8	LED,ICON=1/LCD=8	<input type="text"/>

[1]-[5] Function Key Assignment

Function Key	Button	Valid Range	Default	Function	
[1] Function Key 1 Assignment		00 to 32	03	Stay Arm	<input type="text"/>
[2] Function Key 2 Assignment		00 to 32	04	Away Arm	<input type="text"/>
[3] Function Key 3 Assignment		00 to 32	06	Chime On/Off	<input type="text"/>
[4] Function Key 4 Assignment		00 to 32	14	Command Output 2	<input type="text"/>
[5] Function Key 5 Assignment		00 to 32	16	Quick Exit	<input type="text"/>

Keypad Function Keys

Please see your system installation manual for a complete list of all the function key options available for your system.

[00] - Null	[08] - Bypass Mode	[17] - Activate Stay/Away	[28] - Partition 4 Select
[01] - Partition 1 Select	[09] - Trouble Display	[19] - Command Output 3	[29] - Partition 5 Select
[02] - Partition 2 Select	[10] - Alarm Memory	[21] - Command Output 4	[30] - Partition 6 Select
[03] - Stay Arm	[11] - User Programming	[22] - Activate Camera	[31] - Partition 7 Select
[04] - Away Arm	[12] - User Functions	[23] - Bypass Recall	[32] - Partition 8 Select
[05] - No Entry Arm	[13] - Command Output 1	[24] - Bypass Group Recall	
[06] - Chime On/Off	[14] - Command Output 2	[26] - Time & Date Program	
[07] - System Test	[16] - Quick Exit	[27] - Partition 3 Select	

Keypad Programming

Enter keypad programming by pressing [*][8][Installer Code][*]

[001]-[064] Zone Label 1 to 64 (PK5500\RFK5500 Only)

ex. For Zone 1 enter section [001], for Zone 2 enter section [002] etc. Default: "Zone 1" - "Zone 64"

Section	Zone	Label
[001] to [064]	1 to 64	<input type="text"/>

[065] Fire Alarm Label (28 Characters) (PK5500\RFK5500 Only)

Default: "Fire Zone"

[065]	<input type="text"/>
-------	----------------------

[066] Fail to Arm Event Message (PK5500\RFK5500 Only)

Default: "System Has Failed to Arm"

[066]	<input type="text"/>
-------	----------------------

[067] Alarm When Armed Event Message (PK5500\RFK5500 Only)

Default: "Alarm Occurred While Armed < >"

[067]	<input type="text"/>
-------	----------------------

[071] First User Display Mask

Default	Option	ON	OFF
ON <input type="text"/>	1	Hold [P]anic Key prompt ON	Hold [P]anic Key prompt OFF
ON <input type="text"/>	2	Auto-arm Control/Time prompt ON	Auto-arm Control/Time prompt OFF
ON <input type="text"/>	3	Quick Arm prompt ON	Quick Arm prompt OFF
ON <input type="text"/>	4	Interior Arm prompt ON	Interior Arm prompt OFF
OFF <input type="text"/>	5	Quick Exit prompt ON	Quick Exit prompt OFF
OFF <input type="text"/>	6	Thermostat Control prompt ON	Thermostat Control prompt OFF
OFF <input type="text"/>	7	ACK All Trouble Prompt ON	ACK All Trouble Prompt OFF
OFF <input type="text"/>	8	Music Input prompt ON	Music Input prompt OFF

[072] Second User Display Mask

Default	Option	ON	OFF
ON <input type="text"/>	1	User-initiated Call-up prompt ON	User-initiated Call-up prompt OFF
OFF <input type="text"/>	2	For Future Use	
OFF <input type="text"/>	3	Walk Test prompt ON	Walk Test prompt OFF
ON <input type="text"/>	4	Command Output#1 prompt ON	Command Output#1 prompt OFF
ON <input type="text"/>	5	Command Output#2 prompt ON	Command Output#2 prompt OFF
OFF <input type="text"/>	6	Command Output#3 prompt ON	Command Output#3 prompt OFF
OFF <input type="text"/>	7	Command Output#4 prompt ON	Command Output#4 prompt OFF
OFF <input type="text"/>	8	For Future Use	

[073] Download LCD Message Duration (PK5500\RFK5500 Only)

Default: 003 (Valid entries are 000-255), 000=Unlimited Message Disp.

This number represents the number of times the Downloaded message is cleared by pressing any key while the message is up after timeout).

[074] Key Options

Default	Option	ON	OFF
ON	1	[F]ire Key Enabled	[F]ire Key Disabled
ON	2	[A]uxiliary Key Enabled	[A]uxiliary Key Disabled
ON	3	[P]anic Key Enabled	[P]anic Key Disabled
OFF	4-8	For Future Use	

[076] First Keypad Options

Default	Option	ON	OFF
ON	1	Display Code when Programming	Display "Xs" when Programming
ON	2	Local Clock Display ON	Local Clock Display OFF
OFF	3	Local Clock Displays 24-hr Time	Local Clock Displays AM/PM
ON	4	Auto Alarm Memory Scroll Enabled	Auto Alarm Memory Scroll Disabled
OFF	5	Local Display of Temperature ON	Local Display of Temperature OFF
ON	6	Bypass Options prompt ON	Bypass Options prompt OFF
OFF	7	For Future Use	
OFF	8	Auto-Scroll Open Zones ON	Auto-Scroll Open Zones OFF

[077] Second Keypad Options

Default	Option	ON	OFF
ON	1	Chime Enabled for Zone Openings	Chime Disabled for Zone Openings
ON	2	Chime Enabled for Zone Closings	Chime Disabled for Zone Closings
OFF	3	5th Terminal is Keypad PGM Output	5th Terminal is Keypad Zone Input
ON	4	Language Selection from Any Menu	Language Selection from Installer's
OFF	5	Power LED Enabled	Power LED Disabled
ON	6	Power LED indicates AC present	Power LED indicates AC absent
ON	7	Alarms always Displayed When Armed	Alarms not Displayed When Armed
OFF	8	Low Temperature Warning Enabled	Low Temperature Warning Disabled

[080] PGM Terminal 1

Default: 01 [] [] PGM Output Number

[101]-[108] Partition Labels (PK5500/RFK5500 Only)

ex. For Partition 1 enter section [101], for Partition 2 enter section [102] etc.

Section	Partition	Label
[101] to [108]	1 to 8	

NOTE: Partition 1 Label is also used as the System Label

[120]-[151] Command Output Labels (PK5500/RFK5500 Only)

Default: "Command_Q/P_1" - "Command_Q/P_4"

For Partition 1 Command Q/P 1 to 4 enter [120] to [123]	For Partition 5 Command Q/P 1 to 4 enter [136] to [139]
For Partition 2 Command Q/P 1 to 4 enter [124] to [127]	For Partition 6 Command Q/P 1 to 4 enter [140] to [143]
For Partition 3 Command Q/P 1 to 4 enter [128] to [131]	For Partition 7 Command Q/P 1 to 4 enter [144] to [147]
For Partition 4 Command Q/P 1 to 4 enter [132] to [135]	For Partition 8 Command Q/P 1 to 4 enter [148] to [151]

Section	Part	Cmd. Output	Label
[120]-[151]	1 to 8	1 to 4	

[201]-[264] Door Chime Sound Programming

You can program the keypad to make up to four different door chime sounds for individual zones.
ex. For Zone 1 enter section [201], for Zone 2 enter section [202] etc.

Default	Option	ON	OFF
ON	1	6 Beeps	Disabled
OFF	2	"Bing-Bing" Sound	Disabled
OFF	3	"Ding-Dong" Sound	Disabled
OFF	4	Alarm Tone	Disabled
OFF	5-8	For Future Use	

[995][*] Reset Keypad Options to Factory Default

[996][*] Label Default (PK5500/RFK5500 Only)

[997] View Software Version (PK5500/RFK5500 Only)

[998][*] Initiate Global Label Broadcast (PK5500/RFK5500 Only)

[999][*] Reset Keypad EEPROM to Factory Defaults

Keypad Display Symbols

	8 Bypass — Indicates that there are zones automatically or manually bypassed.
	9 For Future Use
	10 Arm Mode — Indicates the mode the panel is armed in. Stay — Stay — Indicates that the panel is armed in the Stay Mode. It will turn on at the beginning of the Exit Delay
	11 Away — Indicates that the panel is armed in the Away Mode. It will turn on at the beginning of the Exit Delay
	12 Chime — This icon turns on when Door Chime is enabled on the system and will turn off when Door Chime is disabled.
	1 Fire — Indicates that there are fire alarms in memory.
	2 Memory — Indicates that there are alarms in memory.
	3 Ready Light (green) — If the Ready light is on, the system is ready for arming.
	4 Armed Light (red) — If the Armed light is on, the system has been armed successfully.
	5 System Trouble — Indicates that a system trouble is active.
	6 AC — Indicates that AC is present at the main panel.
	7 Program — Indicates that the system is in Installer's Programming, or the keypad is busy.

Wireless Programming (RFK55XX Only)

Enter Wireless programming by pressing [*][8][Installer's Code][804]

[01]-[32] Wireless Device Serial Number Zone Serial Numbers Default = 000000

[01] Zone 1	_____	[17] Zone 17	_____
[02] Zone 2	_____	[18] Zone 18	_____
[03] Zone 3	_____	[19] Zone 19	_____
[04] Zone 4	_____	[20] Zone 20	_____
[05] Zone 5	_____	[21] Zone 21	_____
[06] Zone 6	_____	[22] Zone 22	_____
[07] Zone 7	_____	[23] Zone 23	_____
[08] Zone 8	_____	[24] Zone 24	_____
[09] Zone 9	_____	[25] Zone 25	_____
[10] Zone 10	_____	[26] Zone 26	_____
[11] Zone 11	_____	[27] Zone 27	_____
[12] Zone 12	_____	[28] Zone 28	_____
[13] Zone 13	_____	[29] Zone 29	_____
[14] Zone 14	_____	[30] Zone 30	_____
[15] Zone 15	_____	[31] Zone 31	_____
[16] Zone 16	_____	[32] Zone 32	_____

[41]-[56] Wireless Key Serial Number Wireless Key Serial Numbers Default = 000000

[41] Key 1	_____	[49] Key 9	_____
[42] Key 2	_____	[50] Key 10	_____
[43] Key 3	_____	[51] Key 11	_____
[44] Key 4	_____	[52] Key 12	_____
[45] Key 5	_____	[53] Key 13	_____
[46] Key 6	_____	[54] Key 14	_____
[47] Key 7	_____	[55] Key 15	_____
[48] Key 8	_____	[56] Key 16	_____

[61]-[68] Wireless Function Key Options

Function Key	Key 1	Default	Key 2	Default	Key 3	Default	Key 4	Default
[61] Partition 1	_____	03	_____	04	_____	27	_____	30
[62] Partition 2	_____	03	_____	04	_____	27	_____	30
[63] Partition 3	_____	03	_____	04	_____	27	_____	30
[64] Partition 4	_____	03	_____	04	_____	27	_____	30
[65] Partition 5	_____	03	_____	04	_____	27	_____	30
[66] Partition 6	_____	03	_____	04	_____	27	_____	30
[67] Partition 7	_____	03	_____	04	_____	27	_____	30
[68] Partition 8	_____	03	_____	04	_____	27	_____	30

Keypad Function Keys

Please see your system installation manual for a complete list of all the function key options available for your system.

[00] - Null	[06] - Chime On/Off	[16] - Quick Exit	[27] - Disarm
[03] - Stay Arm	[07] - System Test	[17] - Activate Stay/Away	[28] - Fire Alarm
[04] - Away Arm	[13] - Command Output 1	[19] - Command Output 3	[29] - Auxiliary Alarm
[05] - No Entry Arm	[14] - Command Output 2	[21] - Command Output 4	[30] - Panic Alarm

[69] Wireless Keys (1-16) Partition Assignments Default = 01

Key 1	_____	Key 5	_____	Key 9	_____	Key 13	_____
Key 2	_____	Key 6	_____	Key 10	_____	Key 14	_____
Key 3	_____	Key 7	_____	Key 11	_____	Key 15	_____
Key 4	_____	Key 8	_____	Key 12	_____	Key 16	_____

[81] Wireless supervisory Window

Default: [NA] 96 = 24 hours / [EU] 10 = 2.5 hours _____

The window is programmed in 15 minute increments. Valid entries are 10 to 96, equal to 2.5 to 24 hours.

[82]-[85] Zone Device Supervision Options

Default ON	[82] Zone Supervision ON/OFF	[83] Zone Supervision ON/OFF	[84] Zone Supervision ON/OFF	[85] Zone Supervision ON/OFF
Option 1	1 _____	9 _____	17 _____	25 _____
Option 2	2 _____	10 _____	18 _____	26 _____
Option 3	3 _____	11 _____	19 _____	27 _____
Option 4	4 _____	12 _____	20 _____	28 _____
Option 5	5 _____	13 _____	21 _____	29 _____
Option 6	6 _____	14 _____	22 _____	30 _____
Option 7	7 _____	15 _____	23 _____	31 _____
Option 8	8 _____	16 _____	24 _____	32 _____

[90] Other Options

NA Default	EU Default	Option	ON	OFF
OFF	OFF	_____ 1-4	For Future Use	
ON	OFF	_____ 5	RF Delinquency Disabled	RF Delinquency Enabled
OFF	OFF	_____ 6	For Future Use	
ON	OFF	_____ 7	RF Jam Detect Disabled	RF Jam Detect Enabled
OFF	OFF	_____ 8	Global Placement Test	Individual Placement Test

NOTE: For UL Listed installations, the RF Jam detect feature must be enabled.

NOTE: For DD243 installations, the RF delinquency feature should be enabled.

NOTE: Supervision must be enabled for RF Delinquency.

[93] RF Jam Detect Zone

Default: 00 _____ Valid entries = 01 - 32, 00 = No RF Jam tone selected.

Select an unused zone that will be set to the tamper state when a jamming signal is detected.